

# LOW Profile Hydraulic Torque Wrench Series

## Technical Specifications

Aware of the difficulties associated with flange bolting, the new Christie LOW profile wrenches have an open hexagon to fit directly onto the nut or bolt head. This tooling is ideal for use on applications with limited overhead access or with fasteners having excessive thread protrusion. LOW tools are easy to handle and position due to the light Titanium alloy construction, reversible ratchet system, and swivel 360 degree connections. The use of hexagon reducing sleeves can make each hexagon head versatile for a range of smaller fasteners. Where larger hexagon sizes are necessary, the easy-change, detachable head, requires no additional tooling and therefore minimises downtime.



Model	2LOW		4LOW		8LOW		14LOW		30LOW	
Torque Range Nm	180-2230		440-5740		890-10200		1852-17200		3500-41000	
Bolt Size Range mm	19-55	60	34-65	70-80	41-95	100-105	50-117	95-155	160-175	
Weight of Power Unit Kg	1	1	2	2	3.3	3.3	5.5	11.4	11.4	
Weight of Ratchet Link Kg	1.6	1.7	4.4	4.6	8	8.4	11.6	29	30	
L	186	186	245	245	294	294	362	430	441	
H1	132	135	177	187	209	218	236	309	321	
H2	102.3	105	135.7	145.7	169	178	204	272	285	
W1	32	32	42	42	53	53	64	85	85	
W2	51	51	66	66	83	83	99	131	131	

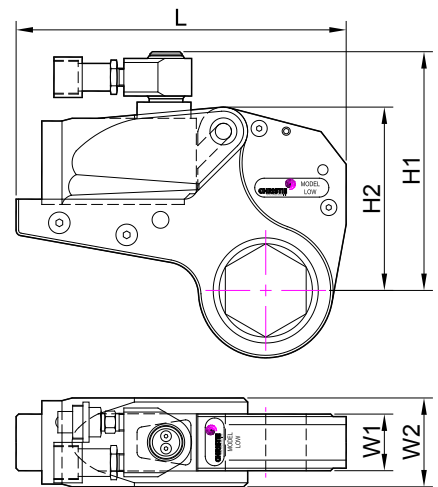

• No statement or data within this literature is warranted or guaranteed to be accurate.

Whilst every effort has been made to ensure the availability of the models and specifications within this catalogue, our policy of continuous improvement means specifications and models are liable to change without notice. We reserve the right to change the specifications and models available for sale or hire and to supply equivalent products where appropriate.

**W.CHRISTIE (INDUSTRIAL) LTD** CHRISTIE HOUSE, MEADOWBANK ROAD, ROTHERHAM, SOUTH YORKSHIRE, S61 2NF, UK.  
T : +44(0)1709 550088 F : +44(0)1709 550030 E : INFO@WCHRISTIE.COM W : WWW.WCHRISTIE.COM

# LOW Profile Series Hydraulic Torque Wrench

## Technical Specifications

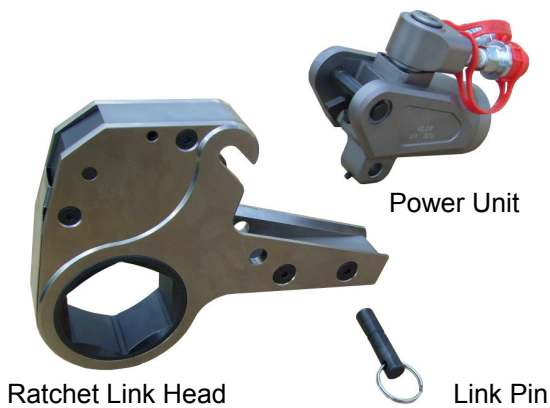

One power unit can be used with different A/F sizes of ratchet link head

Hexagon Size	2LOW	R	A	4LOW	R	A
mm		mm	mm		mm	mm
19	2LOW-19	27	16			
22	2LOW-22	27	14			
27	2LOW-27	27	11			
30	2LOW-30	29	12			
32	2LOW-32	29	11			
34	2LOW-34	31	11	4LOW-34	36	16
36	2LOW-36	31	10	4LOW-36	36	15
41	2LOW-41	34	10	4LOW-41	39	15
46	2LOW-46	37	10	4LOW-46	42	15
50	2LOW-50	40	11	4LOW-50	44	15
55	2LOW-55	43	11	4LOW-55	46	14
60	2LOW-60	46	11	4LOW-60	50	15
65				4LOW-65	53	15
70				4LOW-70	56	15
75				4LOW-75	59	15
80				4LOW-80	61	15

Hexagon Size	8LOW	R	A	14LOW	R	A	30LOW	R	A	Hexagon Size
mm		mm	mm		mm	mm		mm	mm	mm
41	8LOW-41	46	22							
46	8LOW-46	46	19							
50	8LOW-50	46	17	14LOW-50	60	31				
55	8LOW-55	50	18	14LOW-55	60	28				
60	8LOW-60	52	17	14LOW-60	60	25				
65	8LOW-65	55	17	14LOW-65	60	22				
70	8LOW-70	58	17	14LOW-70	60	19				
75	8LOW-75	60	17	14LOW-75	63	19				
80	8LOW-80	63	16	14LOW-80	66	19				
85	8LOW-85	66	16	14LOW-85	69	19				
90	8LOW-90	69	17	14LOW-90	72	20				
95	8LOW-95	71	16	14LOW-95	74	19	30LOW-95	83	28	95
100	8LOW-100	75	17	14LOW-100	77	19	30LOW-100	83	25	100
105	8LOW-105	78	17	14LOW-105	80	19	30LOW-105	89	28	105
110				14LOW-110	83	19	30LOW-110	89	25	110
115				14LOW-115	87	20	30LOW-115	95	28	115
117				14LOW-117	87	19	30LOW-117	95	27	117

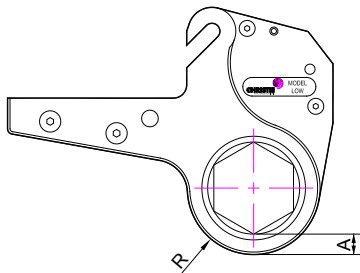

30LOW-120	95	25	120
30LOW-125	101	29	125
30LOW-130	101	26	130
30LOW-135	104	26	135
30LOW-140	110	29	140
30LOW-145	110	26	145
30LOW-150	116	29	150
30LOW-155	116	26	155
30LOW-160	128	36	160
30LOW-165	128	33	165
30LOW-170	128	30	170
30LOW-175	128	27	175



Reducer Inserts to extend the range of nut sizes

• No statement or data within this literature is warranted or guaranteed to be accurate.

Whilst every effort has been made to ensure the availability of the models and specifications within this catalogue, our policy of continuous improvement means specifications and models are liable to change without notice. We reserve the right to change the specifications and models available for sale or hire and to supply equivalent products where appropriate.